

For more great **Hangman Products** go to: <http://www.hangmanproducts.com>

Security Lock Installation

***Fast easy installation with
household tools***

Step 1: Install HANGMAN SYSTEM

Step 2:

Leave the framed mirror / art / decor on the wall, and mark a line along the bottom in the center, 2 to 3 inches long

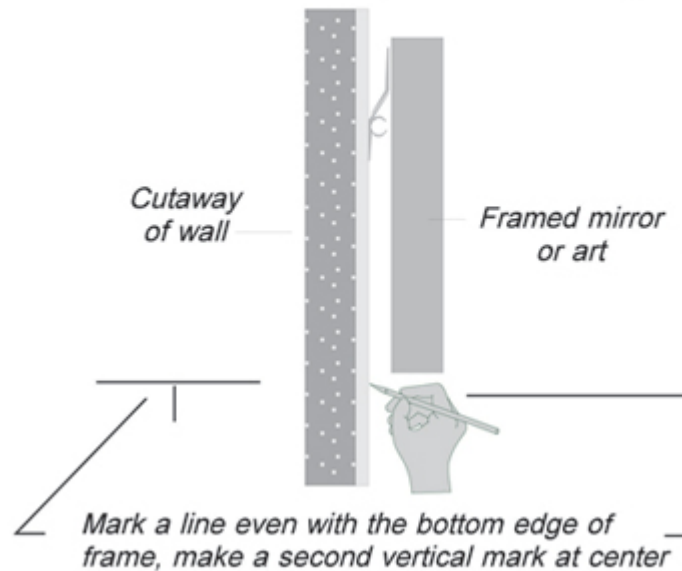

Step 3:

Use supplied templet to set wall anchor location to install part "A"

Match the center line and bottom of template to the marks you made on the wall

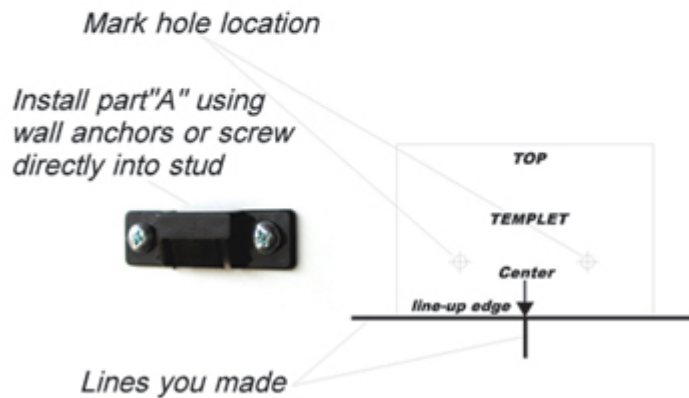

1 lock Set / 1 Security key / Mounting Screws / Templet



Hangman Security Lock Instructions

Step 4:

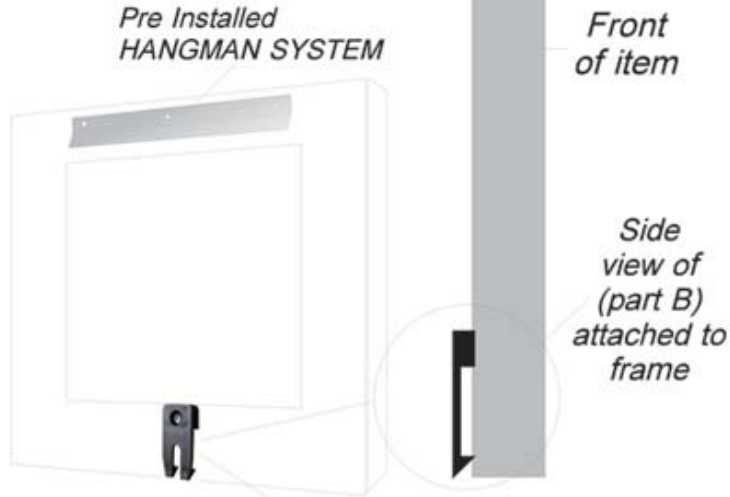

Install part "B" in the center with prongs facing down, and flush with bottom edge of frame

Step 5:

(REMOVE LEVEL)

Hang Mirror / Art / Decor by First holding item against the wall then sliding it down, aiming prongs into spring clip

